



Armatix GmbH
Eichenweg 6
07616 Petersberg
Germany

Armatix GmbH
Feringastraße 4
85774 Unterföhring
Germany

Tel.: +49 89 / 4 27 29 79 - 0
Fax: +49 89 / 4 27 29 79 - 79
E-mail: info@armatix.de
www.armatix.com

QuickLock Locking Elements

QuickLock Locking Elements

QuickLock Locking Elements

Contents

1	Introduction
2	About this operating manual
3	Safety Precautions
3.1	Conventions and symbols
3.2	Safety precautions
3.2.1	General safety precautions
3.3	Intended use
3.4	Liability and warranty
4	Description
4.1	Inspecting the locking element
5	Commissioning of the locking element
5.1	Programming the locking element
5.1.1	Programming a locking element using SmartKey control unit with PIN input
5.1.2	Programming a locking element using SmartKey control unit with biometric input
6	Locking the weapon
6.1	Handguns
6.1.1	Inserting the locking element (muzzle side)
6.1.2	Inserting the locking element (chamber side, PS weapon)
6.2	Rifles

7	Unlocking the weapon
7.1	Unlocking a locking element using "SmartKey control unit with PIN input"
7.2	Unlocking a locking element using "SmartKey control unit with biometric input"
8	Resetting the locking element to the delivery condition
8.1	Resetting to the delivery condition
9	Malfunctions and Remedies
10	Cleaning
11	Storage
12	Repair
13	Disposal

3.2.1 General safety precautions

- Ensure that you have read and understood this operating manual completely before using the QuickLock locking element.
- Store this operating manual together with the locking element at all times.
- Store the PIN and system password (super PIN) of the control unit used for this locking element where it is safe from unauthorised access.
- Use the locking elements only in unloaded weapons.
- Do not use force to insert or remove the locking element.
- On no account should you touch the trigger of the locked weapon.
- Protect the locking element from soiling.
- Do not oil the weapon when the locking element is inserted.
- Also keep any supplements or additions to this operating manual together with the locking element.

3.3 Intended use

The Armatix QuickLock locking elements block the rear barrel area or chamber of a weapon, preventing it from being loaded or fired.

Locking elements can only be removed again using the corresponding control unit.

The unlocking procedure is described in detail in the operating manual "SmartKey control unit with PIN/biometric input".

3.4 Liability and warranty

Armatix GmbH assumes no liability or warranty for incidents arising due to:

- Failure to observe this operating manual,
- Use of a locking element with the wrong calibre,
- Incorrect use of the locking element,
- Improper handling,
- Negligence,
- Use of accessories and spare parts from other manufacturers without the express written approval of Armatix GmbH, or
- Modifications or conversions to the locking element without the express written approval of Armatix GmbH.

4 Description

The QuickLock locking element is a high-precision mechatronic component for weapon safety. The locking element requires no independent power supply and can therefore remain in the weapon for long periods without impairing its function.

QuickLock locking elements are available for all common handgun and rifle calibres.

Locking elements for handguns, with the exception of the PS variants, are inserted from the muzzle side, locking elements for rifles from the chamber side. The locking elements are locked by applying slight pressure.

QuickLock locking elements can only be unlocked using a SmartKey control unit. Removal of the locking element by force will destroy the barrel of the weapon.

INFO

Locking elements for rifles are **not** suitable for insertion using the control unit. Failure to observe this point may result in damage to the surface of the chamber.

4.1 Inspecting the locking element

CAUTION!

Before use, check that the calibre of the locking element and the calibre of your weapon correspond to the C.I.P.-conformant chamber. Use of the wrong locking element may result in malfunctions during unlocking.

➤ *Remedy, see chapter 13*

The calibre designation is shown indelibly on the locking element.

5 Commissioning of the locking element

5.1 Programming the locking element

The locking element is unlocked on delivery. The locking element nevertheless has to be programmed for the intended SmartKey control unit. Proceed as follows:

- Remove the locking element from the packaging.
- Push the locking element onto the plug contact of the control unit with which the locking element is to be unlocked in future. The plug contact must engage noticeably.

5.1.1 Programming a locking element using SmartKey control unit with PIN input

Enter the 4-digit PIN (see card with PIN/super PIN) of the control unit. Each press of a button is acknowledged by the LED flashing green.

Correct input

The LED flashes briefly 3x green, then flashes fast and finally shows a steady green light.

The system password of the control unit has now been transmitted to the locking element. The locking element can now only be unlocked with this control unit.

When the LED goes out, the locking element can be removed from the plug contact of the control unit.

1x or 2x incorrect inputs

LED flashes 3x briefly red.

- Enter the correct PIN (see card with PIN/super PIN).

3x incorrect input

LED flashes 3x briefly red.

If the PIN is entered incorrectly three times, the control unit is locked. After each further incorrect input, the LED flashes red 10x slowly and 3x fast.

After further inputs, even of the correct PIN, the locking element is not unlocked.

- Enable the PIN as described in [chapter 5.1.1.1](#) and repeat the procedure.

5.1.1.1 Enable PIN of the control unit with PIN input

To enable and retain your previous PIN, proceed as follows:

- Press button **1** and hold depressed until the LED lights up green (after approx. 3 seconds).
- Release the button. The LED flashes green 3x.
- Enter the 12-digit system password (see card with PIN/super PIN).

1 Introduction

Dear Customer,
Responsibility is becoming an ever more important topic, particularly among the owners of handguns. With the use of the SmartLock System from Armatix, you are taking on responsibility. Numerous incidents in the past have shown that the dictate of locking weapons away is not sufficient. Only a weapon that cannot be used by unauthorised persons can be regarded as safe.

This condition is achieved by the use of the Armatix SmartLock system. You are thereby also making a major contribution to the safety of the people around you.

We thank you for the faith placed in us and wish you a great deal of enjoyment with the Armatix SmartLock system.

Your Armatix Team

2 About this operating manual

This operating manual describes the function and handling of the QuickLock locking elements for handguns and rifles. The operating manual forms an integral part of the locking element. It must therefore

always be stored with the locking element in order to be available for consultation at any time before use.

This operating manual is intended for persons authorised to own and handle handguns.

3 Safety Precautions

3.1 Conventions and symbols

Dangers are associated with the handling of any weapon; particular attention is drawn to these in this operating manual. The hazard warnings are depicted as follows:

INFO

This pictogram "INFO" gives you tips and recommendations for the use and handling of the SmartLock system.

Information drawing attention at specific points to measures to protect the environment are highlighted as follows:

ENVIRONMENT

This pictogram "ENVIRONMENT" gives you tips and recommendations for the environmentally safe disposal of recyclable materials.

DANGER!

This pictogram with the word "DANGER!" draws attention to an imminent hazard that can result in immediate death or serious injury if not avoided.

- *This arrow directs you to the appropriate measure for avoiding this imminent hazard.*

CAUTION!

This pictogram with the word "CAUTION!" draws attention to an imminent hazard that can result in minor or moderate injury or material damage if not avoided.

- *This arrow directs you to the appropriate measure for avoiding this imminent hazard.*

Information of particular importance at specific points or which simplifies the handling steps described for the user are highlighted as follows:

3.2 Safety Precautions

DANGER!

Mortal danger!

The use of a weapon can create acute dangers for the life and limb of the user, and for third persons and the immediate surroundings.

- *In order to avoid these dangers, please read the following precautions and the operating manual of the weapon carefully and observe them when handling the weapon.*

Correct input of the system password

The LED flashes green 3x.

- Wait approx. 10 seconds and then enter the current PIN correctly. The LED again flashes green 3x.

Wrong input of the system password

The LED flashes alternately green – red 10x.

- Start the PIN enabling process again and enter the 12-digit system password correctly (see card with PIN/super PIN).

5.1.2 Programming a locking element using SmartKey control unit with biometric input**INFO**

In order to be able to program the locking element using a control element with biometric input, 2 administrator fingers and at least 1 user finger first have to be learned (see chapter 6.2.1. and chapter 6.2.2 of the QuickLock control unit operating manual).

Press the button of the control unit with which the locking element is to be unlocked in future once. The LED flashes slowly green.

- Pass your user finger slowly and smoothly across the scanner from the coupling towards the button.

**Successful scan**

If the LED flashes briefly green, the scan was successful and the fingerprint was recognised. The LED then flashes fast green, then changes to a steady green light.

The system password of the control unit has now been transmitted to the locking element. The locking element can now only be unlocked with this control unit.

When the LED goes out, the locking element can be removed from the plug contact of the control unit.

Unsuccessful scan

If the LED flashes red after the scan, either the fingerprint was not recognised or the user has no authorisation.

- Repeat the scan or have an authorised person carry out the scan until the LED flashes briefly green.

INFO

If the locking element has been accidentally programmed with the wrong control unit or if it is to be reprogrammed for another control unit, the locking element first has to be reset to the delivery condition, see chapter 8.1.

6 Locking the weapon**INFO**

Never pull or press the locking element, especially not with tools or other devices.

6.1 Handguns**6.1.1 Inserting the locking element (muzzle side)**

- Ensure that there is no cartridge in the chamber, magazine or revolver drum.
- Clean the weapon and oil in particular the barrel lightly.
- Hold the slide firmly so that it cannot move.
- Push the locking element onto the plug contact of the control unit and insert the locking element into the barrel from the muzzle side up to the bottom of the barrel.
- **Lock the locking element by pressing slightly with the control unit.**

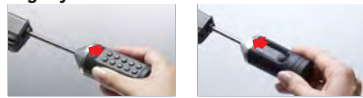

- **The weapon is locked.**
- Pull off the control unit.
- Open the slide of the weapon and check the proper seating of the locking element.

Proper seating of the locking element

The locking element extends to the bottom of the barrel. The weapon is correctly locked.

Incorrect seating of the locking element

- The locking element does not extend to the bottom of the barrel.

Unlock the locking element again as described in the operating manual of the SmartKey control unit, chapter 6.1.1 or 6.2.3, and reposition the locking element. You may have to use a control unit with a long coupling.

The locking element is not locked

Lock the locking element again by pressing slightly with the control unit.

6.1.2 Inserting the locking element (chamber side, PS weapon)

- Ensure that there is no cartridge in the chamber or magazine.
- Dismantle the weapon according to the manufacturer's instructions and remove the barrel.

manufacturer's instructions and remove the barrel.

- Clean the weapon and oil in particular the barrel lightly.
- Insert the locking element from the chamber side by hand until it is seated in the barrel. The locking element side with the plug contact is facing towards the chamber of the weapon.
- **Lock the locking element by pressing slightly by hand.**
- **The weapon is locked.**
- Assemble the weapon again according to the manufacturer's instructions.

6.2 Rifles**INFO**

Locking elements for rifles are **not** suitable for insertion using a SmartKey control unit.

Failure to observe this point may result in damage to the surface of the chamber. Before inserting a QuickLock locking element into a break-action weapon without flanged cartridge, the extractor must first be removed. The same applies before removal of the locking element.

In the case of shotguns with single trigger secured with locking elements, **do not bang the weapon on the floor or against hard objects to relieve the second hammer.** In the case of combined weapons, **all the locking elements must be removed before firing.**

- Ensure that there is no cartridge in the chamber or magazine.
- Clean the weapon and oil in particular the chamber lightly.
- Open the slide and lock it in the open position.
- Insert the locking element into the chamber by hand. The locking element side with the plug contact is facing towards the shaft of the weapon.
- **Lock the locking element by pressing slightly by hand.**



- **The weapon is locked.**
- Remove the lock on the slide.

7 Unlocking the weapon**7.1 Unlocking a locking element using "SmartKey control unit with PIN input"**

See operating manual "SmartKey control unit with PIN input", chapter 6.1.1

7.2 Unlocking a locking element using "SmartKey control unit with biometric input"

See operating manual "SmartKey control unit with biometric input", chapter 6.2.3

8 Resetting the locking element to the delivery condition

If the locking element has been accidentally programmed with the wrong control unit or if it is to be reprogrammed for another control unit, the locking element first has to be reset to the delivery condition. The locking element can be reset to the delivery condition **using any control unit with PIN input.**

This applies also to locking elements programmed using a control unit with biometric input.

8.1 Resetting to the delivery condition

- Push the locking element onto the plug contact of the control unit with PIN input. The plug contact must engage noticeably.

Press button **5** and hold depressed until the LED lights up green (after approx. 3 seconds).

- Enter the 12-digit system password (see card with PIN/super PIN) of the control unit with which the locking element was last unlocked (programmed).

Correct input of the system password

- The LED flashes fast green (communication), then 3x green.
- The locking element is in its delivery condition and can be programmed with another control unit (see chapter 5.1).

Wrong input of the system password

The LED flashes fast red 10x.

- Resetting is aborted. Start the resetting process again and enter the 12-digit system password correctly (see card with PIN/super PIN).

9 Malfunctions and Remedies

This chapter describes possible malfunctions that may occur and corresponding remedial measures that the user can carry out himself.

If the malfunction cannot be remedied with the measures described, please contact your dealer or the manufacturer.

Malfunction	Cause	Remedial measure
Locking element cannot be unlocked	Control unit system password and locking element system password do not correspond.	Use the appropriate operating unit
	Batteries of the control unit too weak	Replace the batteries, see operating manual "SmartKey control unit with PIN/biometric input", chapter 5.1
Locking element can be unlocked, but cannot be removed from the barrel / chamber	Locking element with wrong calibre inserted Locking element pulled to sharply out of the barrel	Contact your weapon dealer or the manufacturer Repeat the process and pull the locking element slowly out of the barrel

10 Cleaning

After removing from the weapon, clean the locking element with a dry, lint-free cloth (e.g. microfibre cloth).

11 Storage

Always store the locking element separately from the card with the PIN/super PIN.

The locking element is made from high-quality stainless steel. Avoid touching the locking element with

damp fingers (perspiration).

Store the locking element in a dry place where it is protected against soiling and direct sunlight (original packaging recommended).

12 Repair

Repairing of the locking element is not possible for safety reasons. If a defective locking element cannot be removed from the weapon, contact your weapon

dealer or the manufacturer.

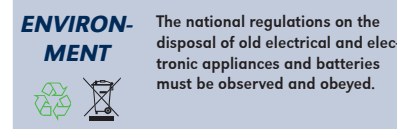
13 Disposal

ENVIRONMENT
The national regulations on the disposal of old electrical and electronic appliances and batteries must be observed and obeyed.

Locking elements contain electronic components and must be disposed of in an environmentally safe manner.

Masthead

Armatix GmbH
Feringastrasse 4
85774 Unterföhring
Germany
Tel.: +49 89 / 4 27 29 79 - 0
Fax: +49 89 / 4 27 29 79 - 79
info@armatix.de
www.armatix.com

Managing directors: Bernd Dietel, Ernst Mauch,
Günter-Maximilian Hefner,
Franz Hermann

Company registered offices: Petersberg
Jena County Court
HRB 501907
VAT ID: DE 235056291
10.2011

Further product information or technical support can be obtained from the contact data opposite.

Legal disclaimer:

Despite the greatest care taken in the compilation of this document, data can change even at short notice. We can therefore give no guarantee or assume any liability for the up-to-dateness, correctness and completeness of the information contained. Content and layout of the operating manual are protected by copyright. Duplication of the pages or their contents shall require the prior written approval of ARMATIX GmbH, insofar as the duplication is not permitted by law.

Copyrights 2011:

Armatix GmbH, Unterföhring.

All rights reserved. Text, illustrations and diagrams and their layout in this operating manual are protected by copyright laws and other intellectual property rights. The content of this operating manual must not be copied, distributed, modified or made accessible to third parties for commercial purposes.